

TITTON
EDITION
JITTON
NC RES. CODE, 2002 EDITION
#2 ALL OTHERS WILL
#3 WITH SPAN OF 3'-7" OR
#4 ALL OTHERS WILL

OF 3'-7" OR LESS
L OTHERS WILL

- R-13 INTERIOR WALL INSULATION
- R-13 INSULATION INSTALLED IN UNDERSIDE OF STAIRS.
- (4) 1 1/2" x 9 1/4" ML FLOOR GIRDER
- USE HIGH WIND PACKAGE

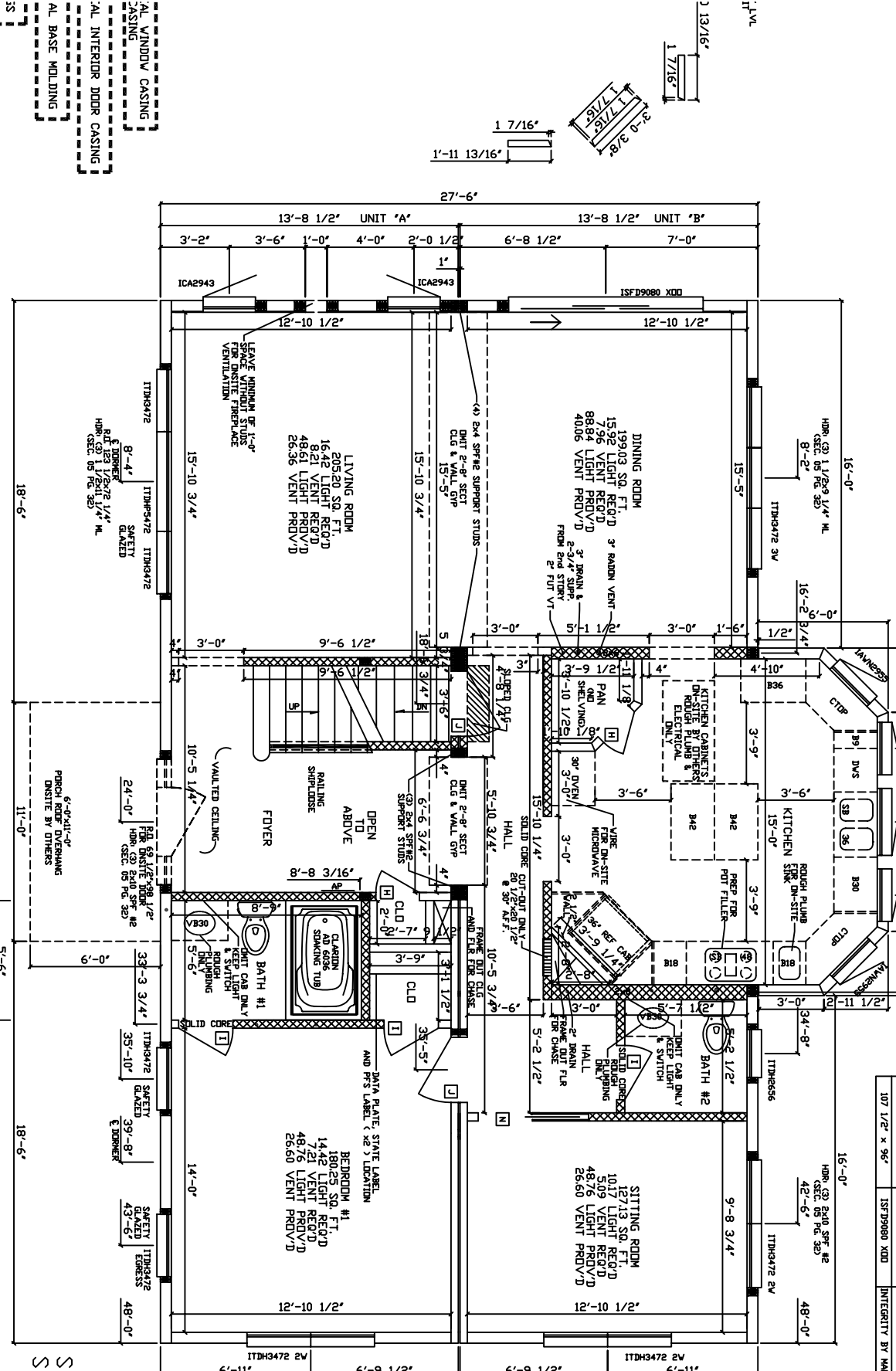

SPECIALTY WINDOW/DOOR SCHEDULE

ROUGH OPENING	MODEL NUMBER	DESCRIPTION
34 1/2" x 72 1/4"	ITDH3472	INTEGRITY BY MARVIN DOUBLE HUNG
68" x 72 1/4"	ITDH3472 2V	INTEGRITY BY MARVIN DOUBLE HUNG
10 1/2" x 76 1/4"	ITDH3472 3V	INTEGRITY BY MARVIN DOUBLE HUNG
26 1/2" x 56 1/4"	ITDH6556	INTEGRITY BY MARVIN DOUBLE HUNG
27" x 55 5/8"	ICAA2955	INTEGRITY BY MARVIN CASSEMENT
29" x 23 5/8"	ICAA2953	INTEGRITY BY MARVIN CASSEMENT
29" x 43 3/4"	ICAA2943	INTEGRITY BY MARVIN CASSEMENT
123 1/4" x 72 1/4"	3472-5472-3472	INTEGRITY BY MARVIN CABRD PICTURE
107 1/2" x 96"	ISFD9080 XDD	INTEGRITY BY MARVIN SLIDING FRENCH DOOR

UNABLE FOR PROVIDING A PROPERLY SIZED
TO COVER A 79,000 BTU LOSS
CALCULATED WITH R-19 FLOOR INSULATION

4. EXT. HDR @ KITCHEN TO BE (3) 1 1/2x18' ML (SEC.05 PG.32)
5. CLG BEAM @ LIV/DIN RM TO BE (4) 1 1/2x18' ML (SEC.05 PG.103)
6. CLG BEAM @ FOYER/HALL TO BE (4) 2x10 SPF #2 (SEC.05 PG.103)
7. 9'-0" HIGH CEILING IN 1ST FLR
- 9.
- 10.
- 11.
- 12.

SIDING=DMIT
SHINGLES=26 1/3 S
Pg 2